

SUCKBACK DIAPHRAGM VALVE

A Furon Product

*Pneumatically
Actuated,
Machined
($\frac{1}{8}$ " , $\frac{3}{16}$ " , $\frac{1}{4}$ " Orifice)*

Features and Benefits

- All wetted parts are from high purity virgin fluoropolymer
- Eliminates dripping of dispense media from nozzles
- Adjustable suckback capacity permits precise metering of dispense media
- Non-metallic pneumatic housing resists corrosion from environment
- Available in molded version
- Up to 30 PSIG (207 kPa) operating pressure
- Easy in-line installation
- Pipe, tube, metric or fractional end connectors



Operation

- Normally closed valve
- Creates vacuum when switching from open to closed position to suck back a predetermined amount of liquid
- Adjustment knob on top of valve gives excellent repeatability on the suckback volume

Applications

- Precise dispense of photoresist, adhesives, solvents and other media

SUCKBACK DIAPHRAGM VALVE

A Furon Product

Pneumatically Actuated, Machined

Ordering Information

PART NO.	END CONNECTION	ORIFICE SIZE	PORT SIZE	A
SBV234	GRAB SEAL *	3/16	1/4	2.84 (72.14mm)
SBV144	FNPT	1/4	1/4	2.04 (51.82mm)
SBV122	FNPT	1/8	1/8	1.86 (47.34mm)
SBV134	FNPT	3/16	1/4	2.04 (51.82mm)
SBV124	FNPT	1/8	1/4	2.04 (51.82mm)

Standard Options

Adjustable Lock Nut.

Standard Options are readily available with slightly longer lead times.

Please consult your local distributor or factory for part number, price and delivery.

Non-Standard Options

Other End Connections available:
Flare Grip**

Non-Standard Options and custom configurations are welcome.

Please consult your local distributor or factory for part number, price and delivery.

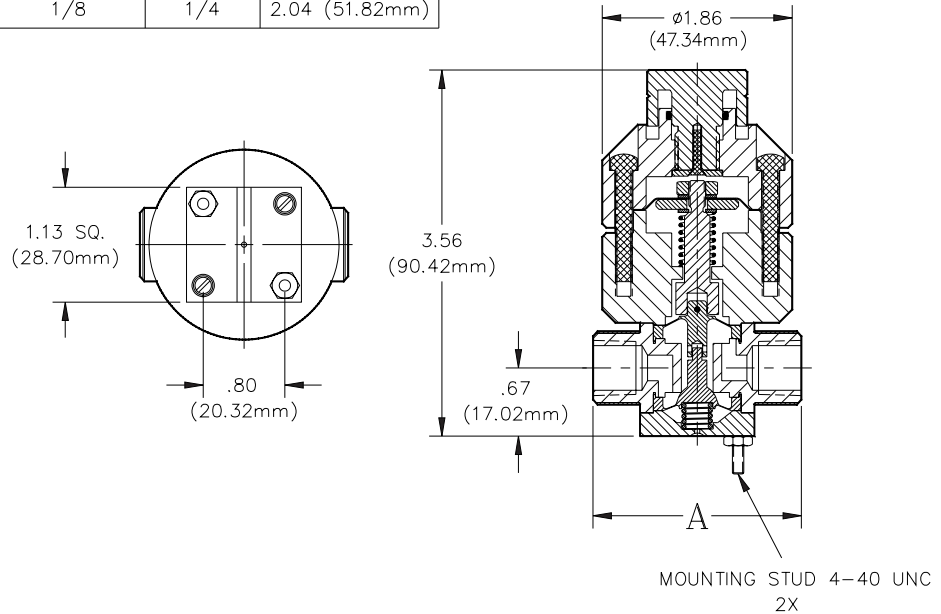

MOUNTING STUD 4-40 UNC
2X

Specifications and Performance

- Maximum Operating Temperature:
158°F (70°C)
- Air Actuator Pressure:
50 PSIG (345 kPa)
- Maximum Operating Pressure:
30 PSIG (207 kPa)
- Maximum Suckback Volume:
100 µl

Notes

Adjusting to near zero suckback amount can cause the valve not to seal fully and leak across the valve seat.
The valve works best if the nozzle is placed no more than four feet (1.2m) from the valve.

* When selecting either Flare Grip® or Grab Seal™ ends, we recommend end connections that are larger than the valve orifice size in order to achieve full flow.

** Theoretical performance data

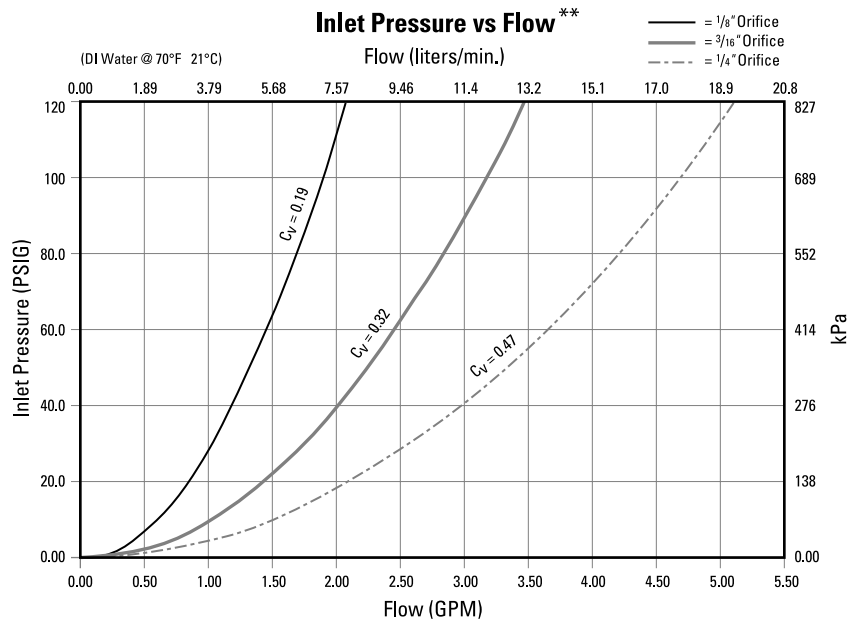

Flare Grip® is a registered trademark.
Grab Seal™ is a trademark.

USA Toll Free: 1.800.833.5661

7301 Orangewood Avenue
Garden Grove, CA 92841-1411
Phone: 714.630.5818
Fax: 714.688.2614

Specifications subject to change without notice.
© 1997
FC 7037 Printed in U.S.A.

SAINT-GOBAIN
PERFORMANCE PLASTICS