

# Furon® HPVM Diaphragm Valve

## Pneumatically Actuated, 2-Way (3/16" & 1/4" Orifice)



### Features/Benefits

- Pressure rated to 80 PSIG (552 kPa)
- Visual position indicator with provision for fiber-optic sensor
- Integral mounting base with top or bottom mount standard
- High purity PFA injection molded body with PTFE diaphragm
- Common port height with manual and 3-way versions
- Semi F57 Compliant

### Operation

- Pneumatically actuated 2 way diaphragm valve is available in normally closed and normally open configurations

### Applications

- Designed for use in ultrapure deionized water and aggressive chemical applications
- Market applications include Semiconductor, Flat Panel, and Photovoltaic manufacturing; Chemical Processing and Biomedical industries

# Furon® HPVM Diaphragm Valve Pneumatically Actuated, 2-Way

## Ordering Information

DESCRIPTION	END CONNECTION	ORIFICE	PORT SIZE	A
HPVM2-744-NC	FUSEBOND™	1/4	1/4	1.66 (42mm)
HPVM2-F34-NC	FLAREGRIP® II	3/16	1/4	3.51 (89mm)
HPVM2-F46-NC	FLAREGRIP II	1/4	3/8	3.71 (94mm)
HPVM2-S30044-NC*	PILLAR S300	3/16	1/4	2.56 (65mm)
HPVM2-744-NO	FUSEBOND	1/4	1/4	1.66 (42mm)
HPVM2-F34-NO	FLAREGRIP II	3/16	1/4	3.51 (89mm)
HPVM2-F46-NO	FLAREGRIP II	1/4	3/8	3.71 (94mm)
HPVM2-S30044-NO*	PILLAR S300	3/16	1/4	2.56 (65mm)

## HPVM 2-Way Pneumatic

- HPV products are also available quarter-turn multi-turn and 3-way configurations with common port heights
- Custom multi-valve manifold designs available to implement complex media flow path requirements where minimal footprint is critical
- Optional fiber optic position sensor detects valve position and provides signal output

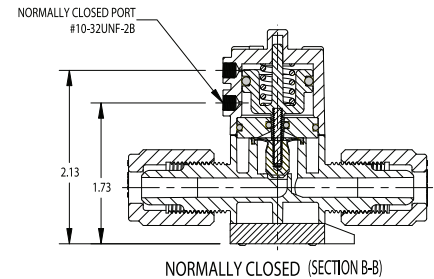
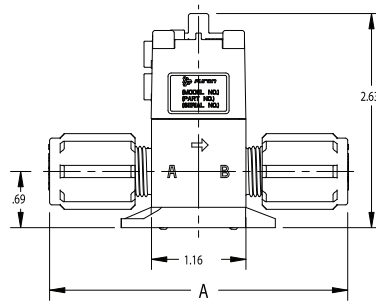
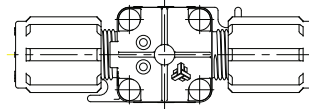

NORMALLY CLOSED (SECTION B-B)

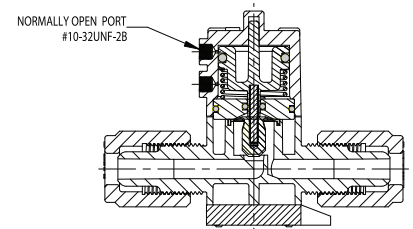

NORMALLY OPEN (SECTION B-B)

## Non-Standard Options

- DI bypass option
- Stroke limit option
- PFA Fine Thread Flare nuts
- Suck Back Dispense/Combo Valve

## Specifications and Performance

- Maximum Operating Temperature: 176°F (80°C)
- Actuator Pressure (Air): 60 PSIG (414 kPa) to 100 PSIG (689 kPa)
- Maximum Operating Pressure (Water): 80 PSIG (552 kPa)
- Vacuum: 25" Hg
- C<sub>v</sub> Factor: 0.7
- Body: High Purity PFA
- Diaphragm: Modified PTFE
- Actuator Housing: Polypropylene
- Stainless steel actuation port inserts (#10-32 UNF-28) available

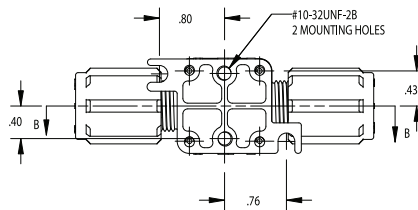

## HPVM2-F46 Flow Vs. Pressure Drop

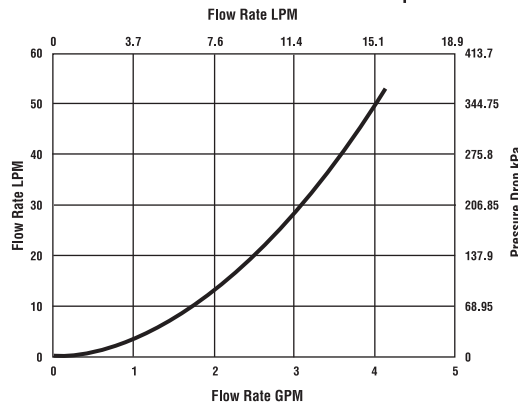

## Saint-Gobain Performance Plastics-USA

7301 Orangewood Avenue  
Garden Grove, CA 92841-1411  
Tel: (714) 630-5818  
Fax: (714) 688-2614  
USA Toll Free: (800) 833-5661

## Saint-Gobain Performance Plastics-France

41 Boulevard des Bouvets  
Nanterre F-92000, France  
Tel: 33/(0) 1 55 68 59 59  
Fax: 33/(0) 1 55 68 59 68



Furon® is a registered trademark.  
FlareGrip® is a registered trademark.  
FuseBond™ is a trademark.

**12-month Limited Warranty:** For a period of 12 months from the date of first sale, Saint-Gobain Performance Plastics Corporation warrants this product to be free from defects in manufacturing. This company's only obligation will be to provide replacement product for any material proven to have such a defect, or at SGPPL's option, to refund the purchase price thereof. User assumes all other risks, if any, including the risk of injury, loss or damage, whether direct, consequential or incidental, arising out of the use, misuse, or inability to use this product. SAINT-GOBAIN PERFORMANCE PLASTICS DISCLAIMS ALL IMPLIED WARRANTIES OF MERCHANTABILITY AND FITNESS FOR A PARTICULAR PURPOSE. Saint-Gobain Performance Plastics reserves the right to change product specifications without prior notice.

NOTE: Saint-Gobain Performance Plastics Corporation does not assume any responsibility or liability for any advice furnished by it, or for the performance or results of any installation or use of the product or of any final product into which the product may be incorporated by the purchaser and/or user.